

# Technical Specification

Class	S300	Remark
Design (Light Head)		
Installation	Single Ceiling Dual Ceiling Mobile	
Head Size (cm)	43.5	
No. of LED (ea)	42	
Intensity (lx)	130,000	Dental : 30,000 Exam : 60,000
Intensity Control	3 Steps (40,000~130,000)	
C.R.I (Ra/R9)	96 / 95	
Color Temp. (K)	3,800 / 4,300 / 4,800	
Light Field Size (cm)	3 Steps (15~25, Circle)	
Detachable Centre Grip	Yes (2X)	
Input Power	100~240Vac, 50/60Hz	
LED Life(Hrs)	60,000	
Option	Wall Controller (Tablet PC) Backup Battery	





Medical LED Illumination  
Surgical LED Light

**Luvis S300**

# Luvis S300

130,000 lx



-  **Illumination Intensity**  
3 Step adjustment (Max. 130,000 lx)
-  **Light Field Size**  
3 Step adjustment (Max. 25cm / Min. 15cm)
-  **Color Temperature**  
3,800K / 4,300K / 4,800K
-  **Color Rendering Index**  
Ra 96 / R9 95
-  **3 Different Modes**  
Surgical mode (130,000 lx)  
Examine mode (60,000 lx)  
Dental mode (30,000 lx)

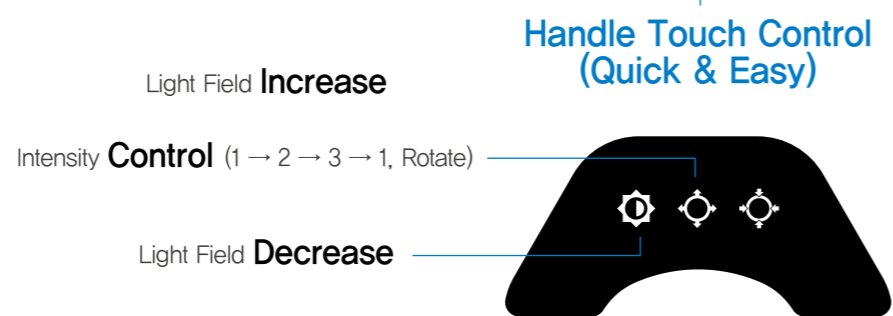

## ARM Touch Control (4.3" LCD)

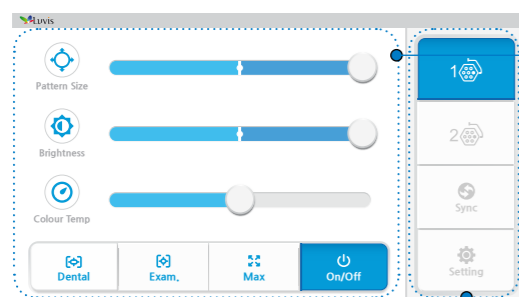

## OT Light (1 or 2) Control

- Light 1 / Light 2 Select
- Light ON/OFF
- Light Field Size, Intensity, Color Temp

## Sync Mode

- OT Light (1 and 2) Sync

## Dental Mode

- Dental Light ON/OFF
- Intensity Control

## Examination Mode

- Examin, Light ON/OFF
- Intensity, Color Temp. Control

## Max. Mode\_OT Light

- Light Field Size 3 Level and Intensity 3 Level Setting

## Light On/Off

OT Light 1 (S300)▼

OT Light 2 (S300)▼

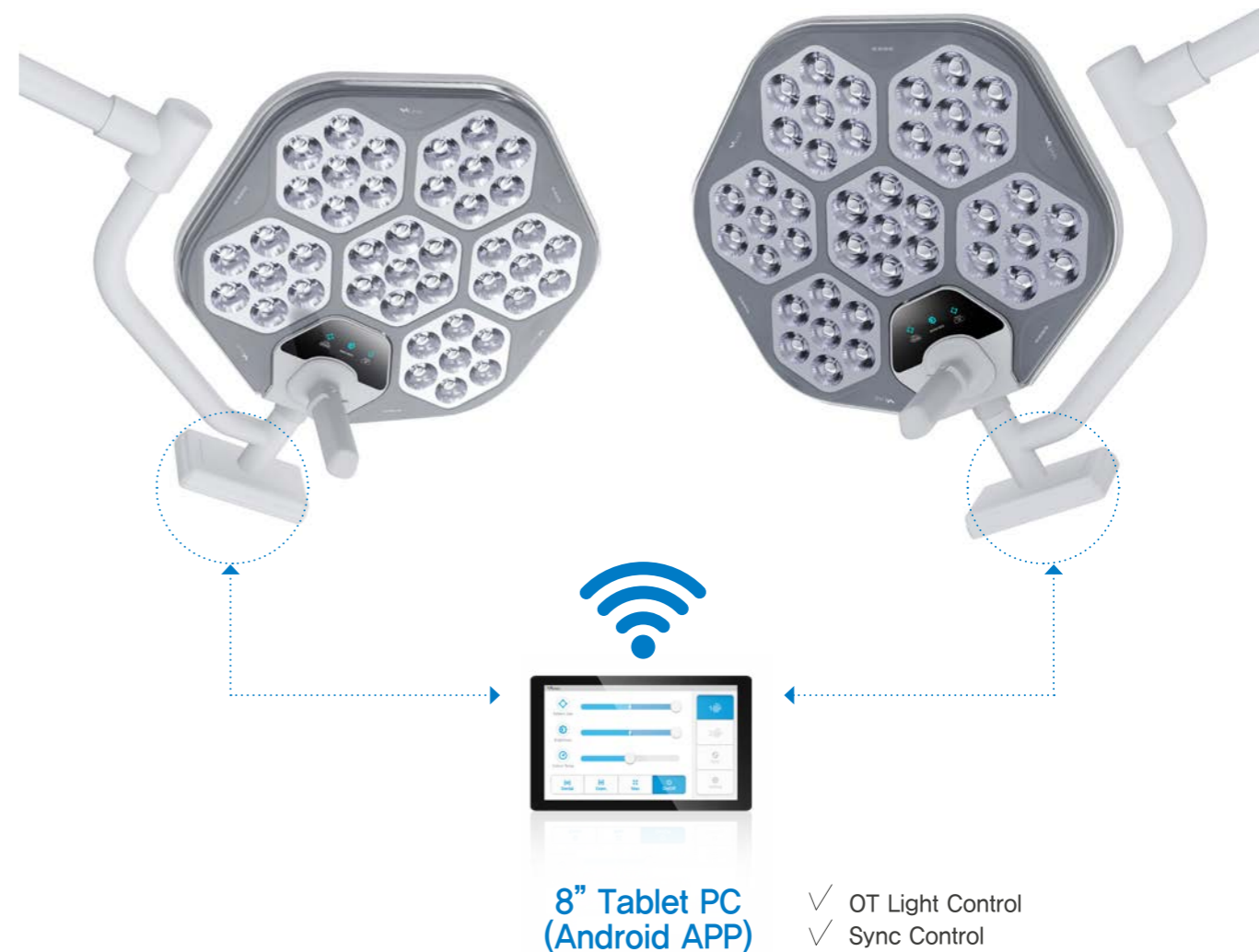

## Back-up Battery

- Over Voltage Detection
- Under Voltage Detection
- Discharging Over Current Detection
- Short Circuit Detection
- Cell Balancing, PTC
- Life cycle : 300 cycle (charge/discharge)
- Duration : 3 Hours

Specifications	
Rating	20~28Vdc, 4A (Lithium-ion Battery)
Dimension	244x164x120mm
Weight	3.8kg

